

TECHNOLOGICAL PRECEDENT STUDY - MASIMBAMBANE COLLEGE MULTIPURPOSE BUILDING

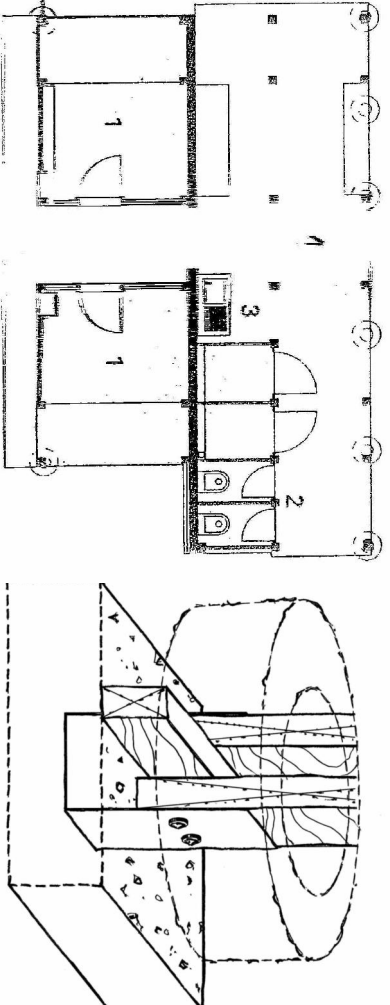
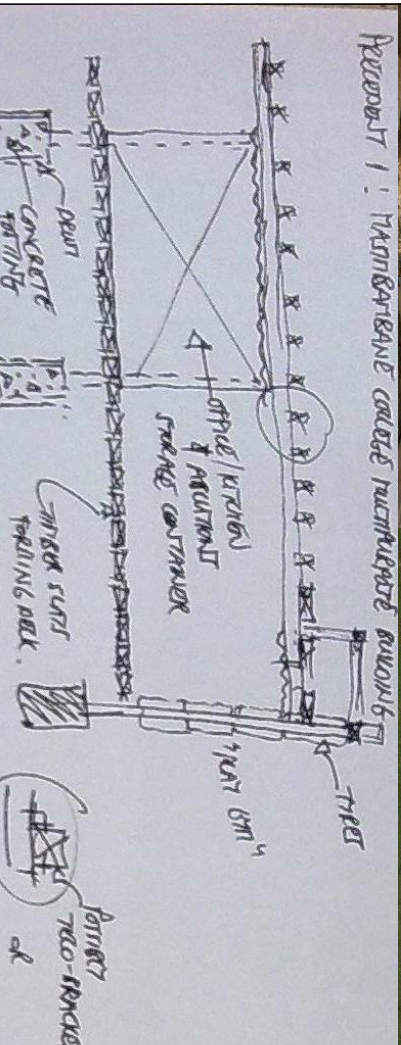
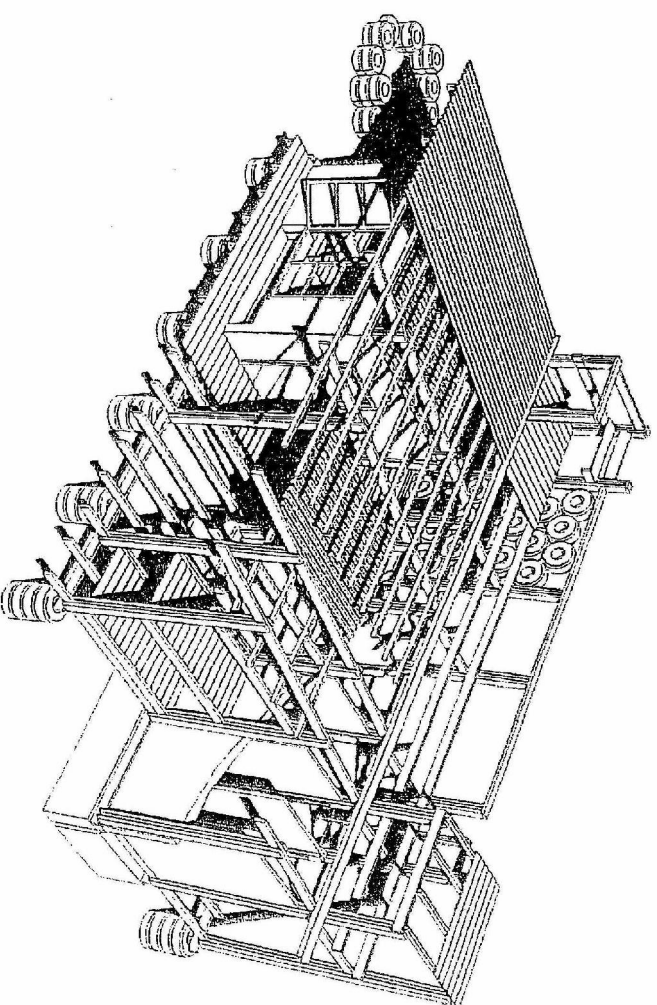
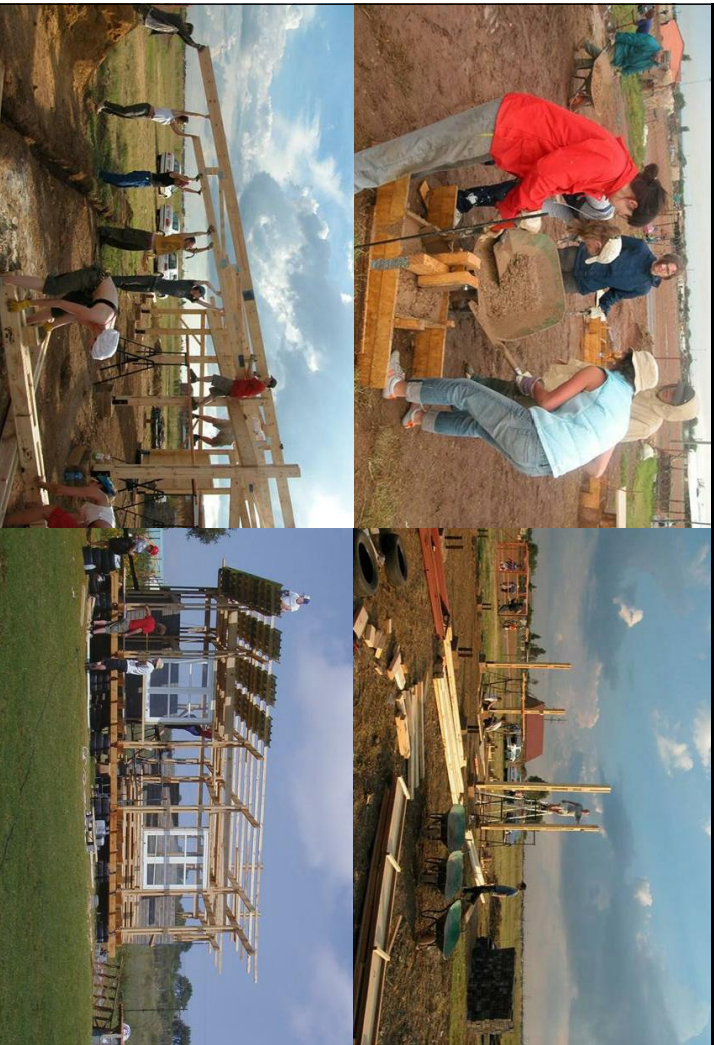

MAIN TECHNOLOGICAL IDEA OF THE BUILDING/ STRUCTURE

THE MAIN TECHNOLOGICAL IDEA IS THAT OF A MULTI - PURPOSE MODULAR LIGHT WEIGHT TIMBER - FRAMED STRUCTURE, WHICH CLEVERLY INCORPORATES A VIEWING DECK FASHIONED AFTER A JUNGLE GYM

TECHNOLOGY

DOUBLE COLUMNED TIMBER POSTS FIXED TO ONE ANOTHER USING THREADED BOLTS. CAR TYRES USED FOR BOTH FUNCTIONAL CLIMBING WALLS AND FOOTINGS. TRANSLUCENT POLYCARBONATE SHEETING IS FIXED TO CERTAIN AREAS OVER THE JUNGLE - GYM AND METAL ROOF SHEETING OVER THE HABITABLE SPACES. A MASONRY ABUTTION CORE PLYWOOD CLADDING

SCALE

THE MASIMBAMBANE COLLEGE MULTIPURPOSE BUILDING HAS A FOOTPRINT OF 75m² AND IS APPROXIMATELY 3.5m's HIGH.

HOW DOES THE TECHNOLOGICAL IDEA CONTRIBUTE TO THE OVERALL IDEA OF THE STRUCTURE

THE MULTI TIMBER POSTS (THIN IN APPEARANCE) CREATES A PERMEABLE AND LIGHTWEIGHT APPEARANCE. THESE POSTS, POSITIONED CAREFULLY IN A GRID PATTERN SUPPORTS THE FUNCTIONAL IDEA OF A MULTI - PURPOSE BUILDING WHICH CAN ALTER AND CHANGE AT ANY TIME. THE TRANSLUCENT POLYCARBONATE SHEETING ALLOWS NATURAL LIGHT INTO THE STRUCTURE SUPPORTING THE IDEA OF "PLAY" - AS IF OUTSIDE. THE USE OF RECYCLED MATERIALS SUCH AS PLYWOOD AND CAR TYRES CONTRIBUTE TO THE MAIN IDEA OF MULTI - PURPOSE USAGE. THE USE OF TYRES FORMING A WALL AND TIMBER SLATS FIXED TO FORM A LADDER CLEVERLY UNITES THE IDEA OF A PLAY - GYM AS ONE NEEDS TO CLIMB AND CRAWL TO ENTER INTO THESE SPACES. AS A JUNGLE - GYM IS OFTEN LIFTED OFF THE GROUND, THIS STRUCTURE CLEVERLY MAKES USE OF TYRES, FILLED WITH CONCRETE TO CREATE A NATURAL STAGE AND FUNCTIONAL FOOTING, ALSO PROTECTING THE TIMBER DECK FROM RISING DAMP. THUS THE TECHNOLOGY EMPLOYED TO CONSTRUCT THE BUILDING, SUPPORTS THE FUNCTIONAL IDEA OF A MULTI - PURPOSE FACILITY WHERE ONE CAN EAT, SLEEP, WORK AND PLAY.

COMMUNITY HUB - "A PERMEABLE SPACE THAT ENCOURAGES FLEXIBLE USE FOR CREATIVE PERFORMANCE"

UDO LOTTER



1966051665